

origin

DEHUMIDIFIER

MODEL : O¹²ⁱ

INSTRUCTION MANUAL

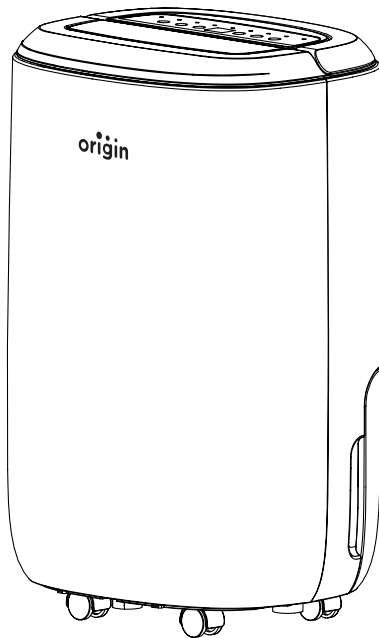

Thank you for choosing this product.
Please read this instruction manual before using it.



Read the user manual before any use, refer to the corresponding section in this user manual.



Recycle unwanted materials instead of disposing of them. All appliances and packaging should be sorted and tendered at a regional recycling centre and be processed in an ecological manner.

CB

The product conforms to the applicable European and other directives.

Figure1

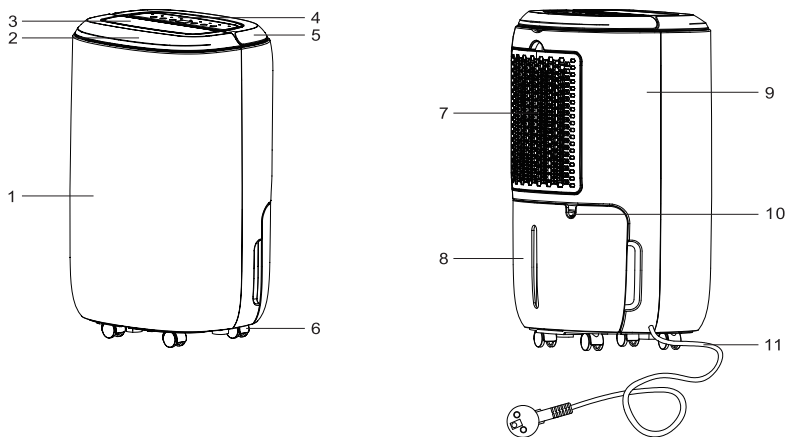

Figure2

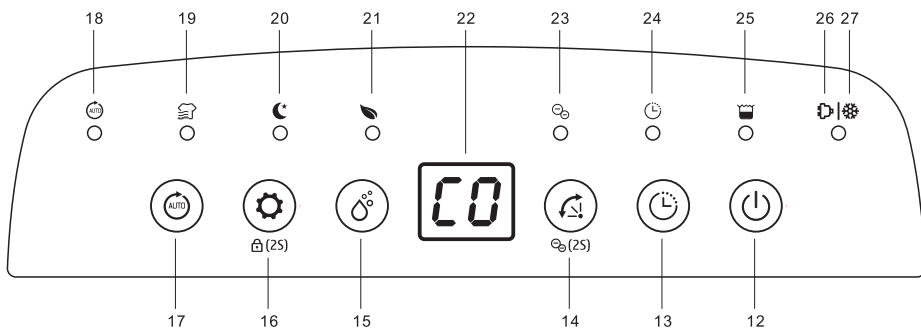
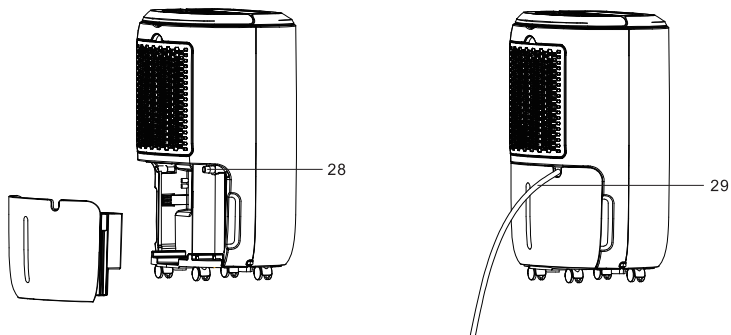

Figure3



Parts List

Components

1. Front Cover
2. Top Cover
3. Air Louver
4. Control Panel
5. Handle
6. Castors
7. Air Inlet Filter
8. Water Tank
9. Rear Cover
10. Drainage Outlet
11. Power Cord

Control Panel

12. Power Button
13. Timer Off Button
14. Mode Button / Anion Button
15. Air Louver Button
16. Manual Dehumidifying Button / Child Lock Button
17. Auto Button
18. Auto Dehumidifying Indicator
19. Laundry Drying Indicator
20. Sleep Indicator
21. Air Purifying Indicator
22. Humidity Reading Display
23. Anion Indicator
24. Timer Indicator
25. Tank Full Indicator
26. Running Indicator
27. Defrost Indicator

Drainage

28. Drainage Outlet
29. Drainage Pipe

Table of Contents

| | |
|-----------------------------|------|
| Product introduction..... | 1-4 |
| Safety Instructions..... | 5-6 |
| Prior to Operation..... | 7 |
| Continuous Drainage..... | 7 |
| Operation Instructions..... | 8-11 |
| Cleaning..... | 12 |
| Storage..... | 13 |
| Display Error Codes..... | 13 |
| Faults..... | 14 |
| Trouble Shooting..... | 15 |

Product introduction

Intended use and conditions of use the dehumidifier is used to remove humidity from the air where there is atmospheric pressure in closed indoor rooms, such as basements, garages or warehouses. The dehumidifier must only be used and stored in rooms larger than 4 sq. meters. The dehumidifier must only be used in compliance with the Technical Data (see last page). Persons with physical, sensory or mental restrictions and children are not permitted to use the dehumidifier. Every user must have read and understood the operating instructions.

Foreseeable misuse

The dehumidifier must not be used:

- In rooms with potentially explosive atmospheres.
- In rooms with an aggressive atmosphere (e.g. caused by chemicals).
- In rooms with water with a pH value below 7.0 or above 7.4.17.
- In rooms with salt or liquids with a salt content >1%, e.g. brine baths.
- In rooms with ozone-treated air, high solvent concentrations or high dust pollution.

General safety information

- **WARNING! Risk of explosion, burns and poisoning from refrigerants!** The appliance contains an odourless, flammable refrigerant which, if handled incorrectly, could result in explosions and fire as well as injuries and burns. The refrigerant circuit is pressurised.
- Do not use any objects to accelerate the thawing process.
- Do not store the dehumidifier in rooms with permanent sources of ignition, such as open flames, operational gas appliances or electric heaters.
- Do not drill open or ignite dehumidifiers.
- Only operate the appliance in an adequately ventilated room larger than 4 m².
- Any work to the refrigerant circuit must be performed by the manufacturer or the manufacturer's authorised technical personnel. Before working on the refrigerant circuit, it must be depressurised using the designated mechanisms.
- Observe the national regulations for gas installations.
- Do not dump refrigerants or dispose of them as household waste.
- Avoid coming into contact with the refrigerant.

WARNING! Electrocutation!

Working on live components or water on live components can cause lifethreatening electrocution. Avoid contact between water and live components.

Always switch off and unplug the dehumidifier and drain away any water before moving it to another location.

Only allow the manufacturer or authorised personnel to carry out work on electric components.

Product introduction

Transport and connection Transport

WARNING! Crushing as a result of instability!

- Transport the dehumidifier in an upright position and secure it so that it cannot tip over or slip.
- Position the dehumidifier on a stable, even surface.

WARNING! Crushing or cutting from reaching into the grille of the air filter!

- Use the handles to transport the dehumidifier.
- Do not reach into the air filter.

CAUTION! Crushing or ergonomic damage when transporting the dehumidifier!

- Use the handles to transport the dehumidifier.
- The dehumidifier must be transported by two people.

Procedure

1. Make sure that the basin is empty / the condensate water has been pumped out.
2. Make sure that the discharge hose (optional) and the mains cable have been disconnected from the appliance.
3. Transport the dehumidifier to where it is going to be used.

NOTE: The air must circulate freely. Do not cover the air openings.

There must be a clearance of at least 1 m in front of the air outlet and the air filter.

ATTENTION! Inadequate appliance output!

- Do not bend the discharge hose.
- Do not place any objects on the hose.

Electrical connection

Procedure

1. Make sure that the supply voltage is the same as the connection voltage in the technical data.
2. Provide an adequate fuse for the socket and the power supply.
3. Install an earth leakage circuit breaker in damp rooms and building sites.
4. Make sure that the mains plug is suitable for the socket of the building.
5. Make sure that the socket used is earthed.
6. Plug the mains plug into the socket.

Product introduction

Maintenance and care **WARNING!** Damage to health from dust!

- Only clean the dehumidifier with compressed air in open spaces.
- Wear a protective mask and goggles.

ATTENTION! Damage to property!

- Cleaning agents can damage surfaces. Only use mild detergents.
- Only use approved original spare parts.

Cleaning and inspection

Procedure

1. Switch off the dehumidifier.
2. Unplug the mains plug.
3. Remove and clean the air filter (e.g. with vacuum cleaner) or replace it.
4. Check the discharge nozzle and discharge hose, if connected.
5. Insert a new or clean filter. Only use an original filter.
6. Plug in the mains cable.
7. Switch on the dehumidifier if necessary.

Troubleshooting: Please check the following points in the event of a fault. If necessary contact our Service Team.

WARNING! Poisoning from refrigerant, burns, crushing or electrocution during maintenance work!

- Only allow the manufacturer or authorized personnel to carry out repairs and maintenance work.
- In the event of malfunctions, switch off the dehumidifier and secure it so that it cannot be switched back on again.
- Allow any hot components to cool sufficiently before working on them.

Decommissioning

Procedure

- Switch off the dehumidifier.
- Empty the basin or pump the water out.
- Unplug the mains plug.
- Cover the dehumidifier with a cloth to protect it from dust.

Product introduction

Storage

CAUTION! Injury!

- Do not stack more than two dehumidifiers on top of each other.
- Secure the dehumidifiers so that they do not fall over.

Disposal ATTENTION! Risk from materials and substances

- Sort materials according to type and recycle in accordance with local regulations.
- When disposing of auxiliary and operating materials, observe the local regulations and information on the safety data sheets.

Safety Instructions

Warning

This appliance is intended for use in a domestic environment only. Any other use is not recommended by the manufacturer and may cause fire, electrical shocks or other person injury and property damage.



Cautions



Wet hands not allowed



Warning

Power Cord

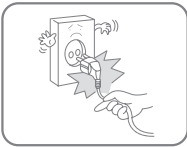

Do not pull the power cord in order to unplug the device from the socket.

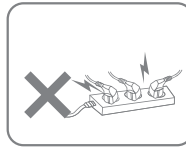

Do not use the appliance in overloaded extension cord.

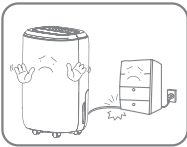

Do not put any heavy objects on the power cord in order to avoid safety hazard.

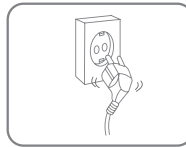

Do not use the appliance if its socket holes cannot firmly hold a plug.



Do not attempt to change the power cord, contact the authorized service centre for repair.



Do not touch the plug with wet hands in order to avoid electric shock.

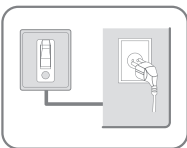

The socket has to be earthed and appropriately secured.

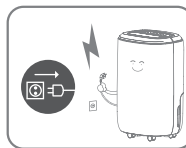

Please pull out the plug during lightning storms.

Safety Instructions

Placement



⊘ Do not put flammable and explosive objects around the appliance in order to avoid fire.

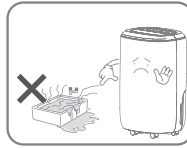

⊘ Do not use the appliance in swimming pool or similar facilities in order to avoid safety hazard.

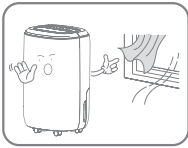

⊘ Do not use the appliance in a draughty place.



⊘ Place the appliance on a stable, flat surface.

During Use

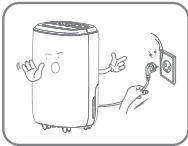

⊘ Please turn off the power and unplug the power cord before moving it.



⊘ Do not pour the water into the appliance in order to avoid malfunction.

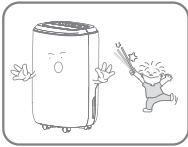

⊘ Children should be supervised to ensure that they do not place stick into the appliance.



⊘ Do not put any heavy objects on the appliance in order to avoid malfunction.

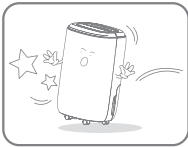

⊘ Do not push the appliance over or let the appliance suffer strong impact in order to avoid malfunction.



⚠ The appliance must not be covered when being used.



⚠ Do not put hands on the air outlet in order to avoid injury or malfunction.

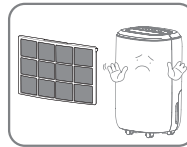

⚠ Please install the air filter before using it.

Prior to Operation

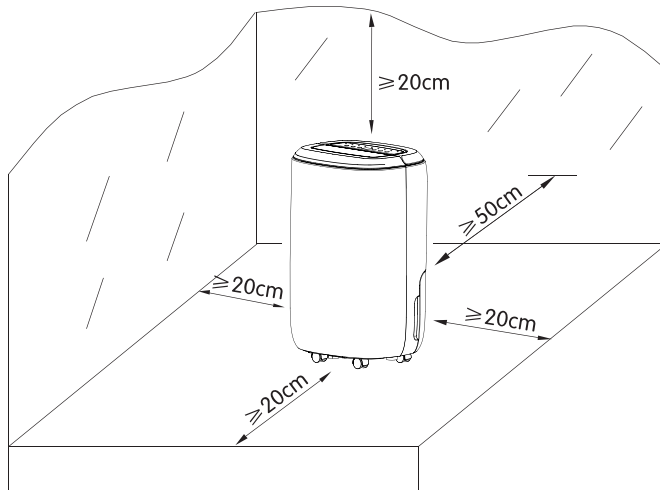

- Place the dehumidifier in an upright position on a stable, flat surface.
- Ensure the dehumidifier is at a safe distance at least 50cm away from a wall or furniture.
- Supply power should be in correspondence with the value on the nameplate, power outlet needs to be grounded.
- Ensure the tank is correctly fitted, if the tank is full or not in place, the tank full light comes on and the dehumidifier will stop working.
- Turn on the power and run the machine as per instructions below.

Continuous Drainage

In general, water will be collected by tank, if you want continuous drainage, please do steps as follows (refer to figure 3)

- a. Remove the water tank.
- b. Push a 14mm internal diameter hose on to the water outlet.
- c. Put the water tank back in place.

Please always make sure the pipe is going downhill, and is not blocked or kinked.

Operation Instructions

Switch On / Switch Off The Unit [Power button]



Connect to the power supply and press the power button once to turn on the unit, the unit runs by default mode on manual continuous dehumidifying with high fan speed, the on/off indicator will be on.

Press the power button to turn off the unit, it will stop working, fan will work for some seconds to blow out the hot air inside the unit.

Auto Shut-off Timer Function [Timer button]



Press the timer button to select your preferred timer hour from 00-24-00 for automatic shut off setting by each press.

Auto timer off setting will be canceled if press timer button for 2 times in 3 seconds.

Auto timer off setting will be canceled if switch off the unit and switch on again.

Humidity Setting [Manual button]



Press the manual button to select your preferred humidity from CO-30%-35%-40%-45%- 50%-55% -60%-65%-70%-75%-80%-CO. CO means continuous dehumidifying regardless of ambient humidity.

When the target humidity is reached, compressor stops immediately, fan will stop 3 minutes later, then stop for 27 minutes. After that, the fan will start in low fan for 2 minutes to detect the humidity, if RH% is 3% higher than set value, the machine will start working, otherwise, the machine will stop for another 27 minutes and repeat this logic.

Operation Instructions

Air Louver Function [Air Louver button]



Press the Air Louver button to change the louver direction.

Multifunction Optional [Mode button]

• Laundry Drying Mode



At manual mode, press the mode button once to select Laundry Drying function, the unit runs in continuous dehumidification with high fan speed for 10 hours then switch off automatically.

💬 Timer button is invalid.

• Sleep Mode



Press the mode button 2 times to select Sleep function, the unit runs with a designated humidity setting of 55% along with low fan speed. All indicators will be off 5s after the setting is completed. Touch any button to activate the light, and to operate as usual.

💬 With no further operation after activate the light for 30s, lights will be off again.

💬 When the water tank is full on sleep mode, water tank full indicator will always be on.

Operation Instructions

• Air Purifying Mode



Press the mode button 3 times to select Air Purifying function, the unit runs with high fan speed without dehumidifying, and the anion function will switch on automatically.

Auto Dehumidifying Function [Auto button]



Press the auto button to select the auto dehumidifying mode, the unit runs automatically accordance to the ambient humidity detected below.

| Ambient RH% detected | Compressor | Fan Speed Level |
|----------------------|------------|-----------------|
| RH% > 65% | Working | High |
| 55 ≤ RH% ≤ 65 | Working | Low |
| RH% < 55% | Stop | Low |

Anion Function [Manual button-2 seconds]



Press and hold manual button for 2 seconds to activate the Anion function to fresh up the air quality.

💬 Anion function will be off automatically when the fan stops working.

Operation Instructions

Safety Childlock Function [Mode button-2 seconds]



Press the Mode button for 2s to lock all buttons with a beeping sound, the same operation can unlock it.

💬 Safety childlock function can be set at standby mode and working mode but can't be activated when water tank is full.

Auto Shut off with Water Tank Full Indicator



The unit will enter into the standby mode when water tank is full or the water tank is not installed properly. After emptying the tank, or install the water tank properly the unit will go on to the previous mode.

💬 Except for the power button, all other buttons are invalid.

Low Temperature Defrost Indicator



When the ambient temperature is too low, dehumidifier will enter into the defrost mode, the unit runs with high fan speed without dehumidifying.

Memory Function:

- When unplugged directly or power cut, then reconnect to the power supply, the dehumidifier will run with the mode prior to the shutdown. The timer setting will be kept.
- Press the power button to switch off the dehumidifier, and then press the power button to switch it back on. The dehumidifier will run with the mode prior to the shutdown. The timer setting will be canceled.
- Switch off the dehumidifier and unplug the power cord, then reconnect the power supply and switch on the dehumidifier. It will run as factory preset mode the first time you received the dehumidifier.

Cleaning

When used regularly, the filter may become clogged with dust and particles. Therefore the filter should be cleaned at least every two weeks. Follow these steps:

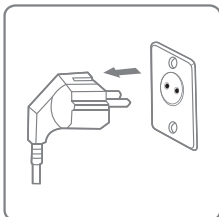

1. Switch the device off and remove the plug from the socket before cleaning.

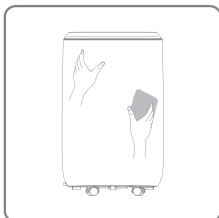

2. Clean the housing with soft, dry cloth. If the device is extremely dirty, use a mild cleaning agent. Wipe the dehumidifier with a slightly damp cloth. Never spray the device with water.

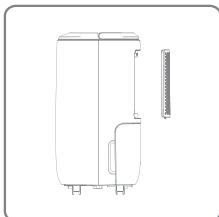

3. Remove the filter, clean the filter with a vacuum cleaner or soapy water no hotter than 40°C.

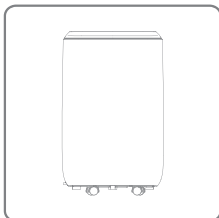

4. Rinse and dry the filter completely before installing back to the device.

Storage

If the dehumidifier will not be used for a long period of time, take the following steps:

1. Remove the plug from the socket and empty the tank, make the tank and the dehumidifier dry completely, this may take a couple of days.
2. Clean the air filter.
3. Check the dehumidifier for perfect condition to ensure a safe use of it after a long period of storage.
4. Pack the device with the suitable packaging.
5. Store the dehumidifier in a dust-free and out of direct sunlight location, preferably covered with a sheet of plastic.

Display Error Codes

Please contact local distributor if any of the error codes below appears.

| Display Code | E1 | E2 | L3 | L4 |
|-------------------|--------------------------|--|---|--|
| Error | Temperature sensor error | Humidity sensor error | Air inlet temperature is too high >42°C | Air inlet temperature is too low <0°C |
| Display | Flash every 30 seconds | Flash every 30 seconds | Slowly flash L3 | Slowly flash L4 |
| What is happening | Machine works normally | Machine works normally, but can't set the humidity | Compressor stop working, fan works at low fan speed. 10mins later, if the temperature decrease to below 40°C, machine will work normally. | Compressor stop working, fan works at low fan speed. 10mins later, if the temperature increase to above 2°C, machine will work normally. |

Faults

| Possible Problem | Possible Cause | Remedial Action |
|--|---|---|
| The dehumidifier is not performing well/ removing moisture. | Air filter is dirty. The dehumidifier is not getting enough air. Dirty filters can damage the appliance in the long term. | Clean the filter or replace if necessary. |
| The dehumidifier is out of operation / fan and compressor are not working. | Dehumidifier is switched off. | Switch on the dehumidifier. |
| | There is no power supply to the dehumidifier. | Check the power supply. |
| Pump fault. | Pump is blocked, e.g. water cannot drain out of the discharge hose/basin. | Check the discharge hose/basin, if connected. |
| | Pump faulty. | Contact our Service Team. |

Trouble Shooting

Check the following before contacting technical support .

| PROBLEM | POSSIBLE CAUSE | SOLUTION |
|--|--|--|
| The device does not work | The power is not connected | Insert the plug into the wall outlet |
| | The water tank is full | Empty the tank |
| | The tank has not been replaced correctly | Replace the tank |
| Water removal capacity is too low | Runtime is too short | Be patient and wait |
| | Ambient temperature or humidity is too low | It is normal that the device does not dehumidify in these conditions |
| The device works, but reduces the relative humidity insufficiently | The room is too big | We recommend using a dehumidifier with a greater capacity |
| | There is too much ventilation | Reduce ventilation(e.g. close windows and shut doors) |
| | The air filter is clogged | Clean the air filter |
| | Set humidity is higher than the ambient humidity | Set the humidity lower than ambient humidity |
| Dehumidifier is blowing out warm air | The dried air is passed over heating coils before it is blown into the room as part of the dehumidifying process | This is normal, a dehumidifier is not an air cooler |
| The display is not showing the humidity set point | The display shows the room relative humidity not the set point | Press the humidity control button once to see the target relative humidity |
| Water on floor | There is residual water in tank, and the device is lurched too much by moving | Be careful when move the tank |
| The dehumidifier is noisy | The air filter is blocked or the device is on an uneven surface | Clean the filter or put the device on a flat surface |

Origin Corporate Services Pvt Ltd.
Address: 906, Dalamal Tower, Nariman Point, Mumbai - 400 021.
Tel : +91 915 200 49 49 | +91 22 49267267 | +91 22 49267201
Web Site : www.origincorp.com | Email : response@origincorp.com