

origin



**introducing  
origin dehumidifier  
ceiling & wall mounted**

# oc 90 Ultra Thin Ceiling Dehumidifiers



**Super Thin Design**  
to maximize ceiling space



**Quiet Operation**  
adopts low noise centrifugal fan, with the features of a large air flow



**Intelligent Humidity Controls**  
set the humidity and view it on a large display panel



**Maintain Easily**  
maintenance of the ceiling dehumidifier can be carried out on the side of the ceiling dehumidifier



**Reliable Water Pump**  
discharges water upto 1.20\* meters



**Quick Defrost**  
hot gas bypass



# OC 90

Specifications

Extraction (30oC RH80%)	l/day	90
(27oC RH60%)	l/day	60
Recommended Coverage (Indicative)*	cu.ft.   cu.mt.	9,000   254
Power consumption   Power Supply 220 V / 50 Hz	watts	1020
Air Flow (Low Fan Speed   High Fan Speed)	m³/h	550   600
Noise level (Approx.)	db(A)	52
Dimensions (W X D X H)	inches	42 x 30 x 13
Trap Door Dimesions (Width X Depth)	inches	60 x 60
Water Pump		Condensate Drainage With Water Pump*
IP Rating		IP×4
Compressor		Rotary
Refrigerant		R410A
Net Weight	kgs	65.0
Working temperature		5°C - 38°C
Timer		1 ~ 24h



Industries

-   
 Healthcare
-   
 Pharma
-   
 R & D
-   
 Hotel
-   
 Warehousing
-   
 Printing
-   
 Food
-   
 Museum &  
 Art Galleries
-   
 Defense

# oc 90 Model Drawings

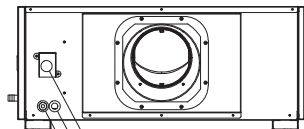

- Display Panel Connection Port
- 485 Communication Connector
- Power Cord Connection Port

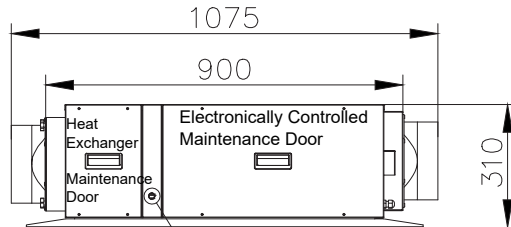
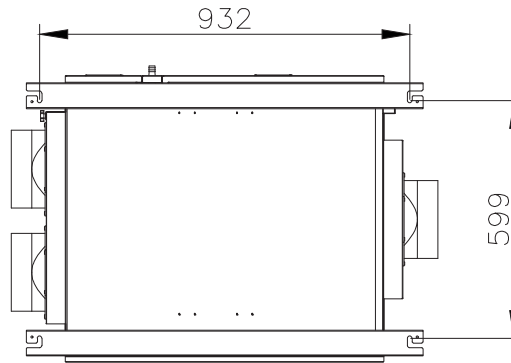
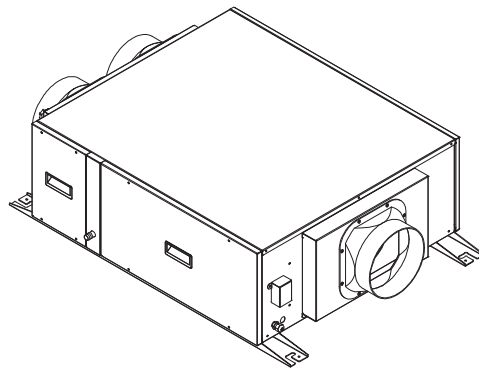

External Diameter  $\phi$ 1 6 Water Pipe Connector

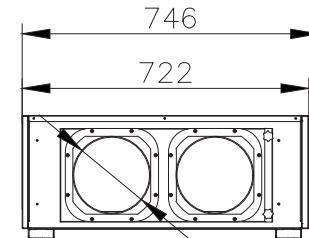

3- $\phi$ 196

