

origin

INDUSTRIAL DEHUMIDIFIER

MODEL : O¹³⁰

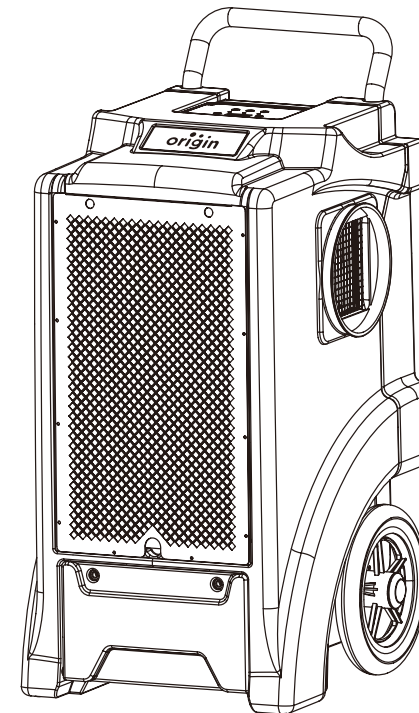

INSTRUCTION MANUAL

SAVE THESE INSTRUCTIONS FOR FUTURE REFERENCE

Thanks for choosing Origin de-humidifiers. We highly recommend you to have a careful reading of the instructions before using the devices. It will provide you with necessary information for proper use and maintenance.

Origin Corporate Services Pvt Ltd.

Address: 906, Dalamal Tower, Nariman Point, Mumbai - 400 021.

Tel : +91 915 200 49 49 | +91 22 49267267 | +91 22 49267201

Web Site : www.origincorp.com | Email : response@origincorp.com

FAULT CODES

WARNING:

In the event of a fault code, contact your service agent.

CODE	E1	E2	E3	E4
Error message	Coil sensor error	Humidity sensor error	Low or no refrigerant	Water pump fault or blockage
Display Reading	Flashes every 30 sec's	Flashes every 30 sec's	Flashes continually	Flashes continually
Reason	Timed defrost mode, the dehumidifier is working correctly.	50% R.H displayed, continuous mode in operation.	Turn power OFF, then turn ON again.	Dehumidifier will turn OFF automatically, the fault must be rectified before operation can commence.

TECHNICAL SPECIFICATIONS

Model	Q 130
Moisture Removal Capacity	130L/day(30°C RH80%)
	70L/day(27°C RH60%)
Power Supply	220-240V~ 50Hz
Rated Power	1190W
Rated Current	5.3A
Refrigerant	R410A/1kg
Operating Temperature	5~35°C
Net Weight	65 kg
Product Size	22×23×38 in

GENERAL INFORMATION

Packaging

- Please DO NOT dispose of any packaging until you have checked the appliance is operational.
- After removing the packaging ensure the contents are intact and complete. In the unlikely event of missing parts; contact your retailer.
- DO NOT leave children unattended with any of the packaging as it is a potential source of danger.
- Disposal of all packaging must be carried out responsibly & safely and in accordance with your local authority regulations.
- ALWAYS recycle the packaging material where possible.
- **When using any electrically powered product, basic safety precautions should always be followed.**
- **PLEASE READ THE INSTRUCTIONS CAREFULLY AND IN FULL BEFORE USING THE PRODUCT.**

IMPORTANT INSTRUCTIONS

WARNING - to reduce the risk of fire, electrical shock or injury to persons or property:

- Always operate the product from a power source of the same voltage, frequency and rating as indicated on the product identification plate.
- Close supervision is necessary when any product is used by or near children the elderly or the infirm. Do not allow children to use the appliance as a toy.
- Do not operate this product with a damaged power cord plug. If the supply cord is damaged it must be replaced by qualified personnel or other similar qualified persons in order to avoid hazard.
- To reduce the risk of electric shock, do not expose the unit or flexible cord to moisture of any kind.
- Switch off and unplug from the power socket when not in use, before assembling or before cleaning.
- Do not place object on the product or allow objects to obstruct the inlet or outlet openings, or operate in close proximity to walls or curtains, etc.
- The use of attachments or accessories not recommended or sold by the product distributor may cause injury to persons or damage to property.
- This product is intended for normal light commercial use only.
- Do not attempt to dismantle the appliance.
- Do not operate the appliance on a metal surface.
- Do not use the appliance in artificially hot or humid conditions or allow to be used in a hazardous environment.
- Do not clean the appliance with organic solvent.
- This appliance is not intended for use by persons (including children) with reduced physical, sensory or mental capabilities, or lack of experience and knowledge unless they have been given supervision or instruction concerning use of the appliance by a person responsible for their safety.
- Children should not be left unsupervised with the appliance.
- This instruction manual is an integral part of the appliance and should be stored for safe keeping and must always accompany the appliance in the event of ownership transfer or for reference to by service engineer.

TROUBLE SHOOTING

PROBLEM	CAUSE	SOLUTION
Dehumidifier does not operate	No power to appliance	Connect plug to power socket
	Switch not turned on	Switch on
	E4 error is displayed	Check drainage flow
Dehumidifier collects little water	Insufficient working time	Allow more working time
	Filter is blocked	Clean filter
	Low ambient temperature	Increase ambient temperature
	Condensate hose is blocked	Check hose for restrictions
Dehumidifier is operating but room is not drying	Doors and windows are open	Seal room from external areas

WARNING:

DO NOT attempt to rectify faults using unqualified personnel.

MAINTENANCE REPLACING THE BATTERY

1. Remove the screws in the four corners of the control panel.
2. Once the screws are removed, carefully lift the control panel to access the PCB.
3. On the PCB is a 9V 6F22 battery. Remove the battery and replace with a new battery.
4. Refit the control panel onto the PCB.
5. Refit the four screws.

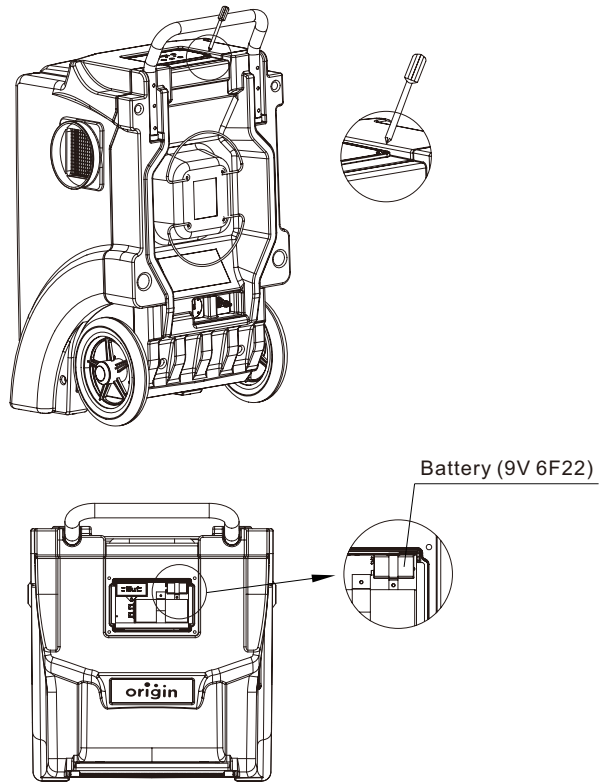

STRUCTURE DIAGRAM

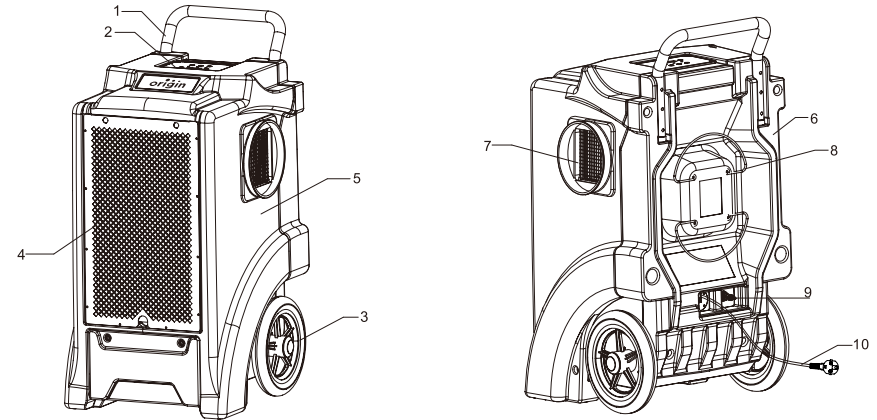

1. Handle
2. Control Panel
3. Wheel
4. Air Inlet Grille
5. Front Housing

6. Rear Housing
7. Air Outlet Grille
8. Drain Hose Bracket
9. Drain Hose Connector
10. Power Cord

WARNING

DO NOT OBSTRUCT THE AIR INLET OR OUTLET.

SETTING UP INSTRUCTIONS

IMPORTANT

Place dehumidifier in the upright position. When transporting a dehumidifier to site, allow the dehumidifier to stand for 30 minutes before switching ON. This is necessary to allow the refrigerant system to stabilise and avoid system damage .

SETTING UP THE DEHUMIDIFIER:

Operate the dehumidifier in an enclosed area as this creates a drying chamber. Close all doors, windows or areas that open to external areas to maximize the dehumidifier's water removal efficiency. Keep traffic through the drying chamber to a minimum. Place the dehumidifier in the centre of the room away from walls and furnishings. DO NOT allow the airflows to be obstructed.

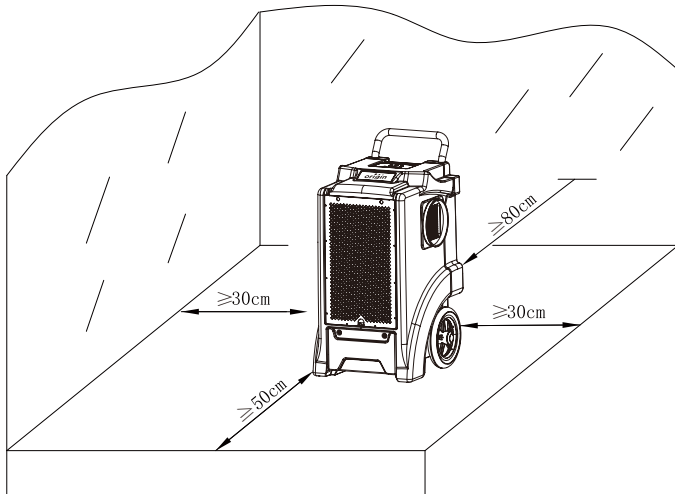

Illustration of correct positioning for best performance

MAINTENANCE CLEANING THE AIR FILTER

Ensure the dehumidifier is turned OFF and the plug is removed from the power socket before maintenance is carried out.

The working performance of the dehumidifier will be greatly reduced if the filters become blocked.

1. Remove the filter as shown in the diagram.
2. Vacuum any debris from the filter using the vacuum hose and nozzle attachment.
3. Using luke-warm water and a mild detergent wash the filter and allow to dry.
4. Once dry, re-install the filter into the dehumidifier.

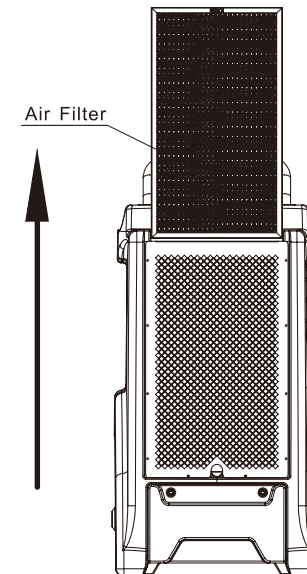

OPERATING INSTRUCTIONS

Operation for general use:

Press the ON/OFF key to turn the unit on ,it will get into working mode automatically.

After using, press ON/OFF key to turn the unit off, while water pump will turn on automatically for 40 seconds to drain the rest water ,and turn off automatically.

Attention:

DO NOT switch the power **OFF** by disconnecting at the main socket outlet. To avoid water spillage; **DO NOT** move the dehumidifier for at least 3 minutes after turning the power **OFF**.

Key lock function

If the keys of “T” and “P” are pressed for 2s at the same time, the operating light will keep shining at the speed of 10Hz, and all the keys on the control panel will be in locked, it can be unlock by the same action again.

Vent hose function

As to a much wetter space, use a vent hose with diameter larger than 164mm. Attach the vent hose to the exhaust ring (see below) to speed up drying the wet area.

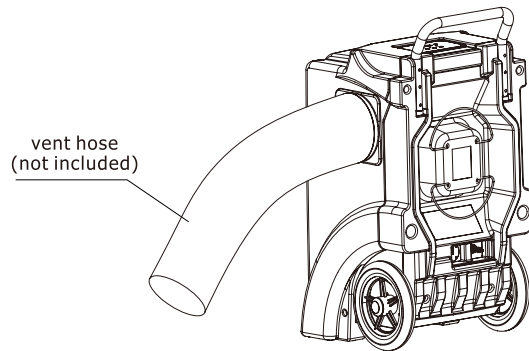

SETTING UP INSTRUCTIONS

DRAINAGE:

The dehumidifier pump connects to a plastic drainage hose. The hose is stored on the back of the appliance. Uncoil the entire hose ensuring there are no kinks or restrictions and place the unattached end into a water vessel or run to outdoors.

Ensure that water which runs to outdoors does NOT create a slip hazard.

Water vessels MUST be checked regularly when used.

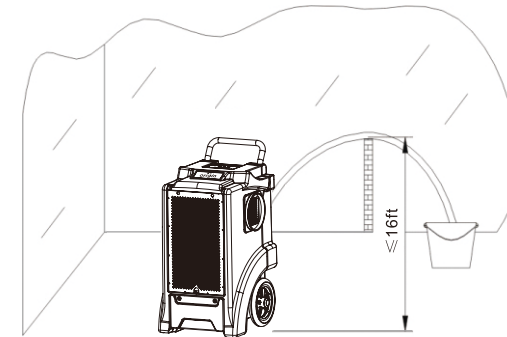

Note:

- The drain hose for the water pump can drain up to 4.5m vertically. More than 4.5m may cause water back up to the pump resulting in leakage.
- When turn off the unit, please take out the water pipe from bucket and empty water inside bucket to avoid the water back flow cause water leakage.

CONTROL PANEL

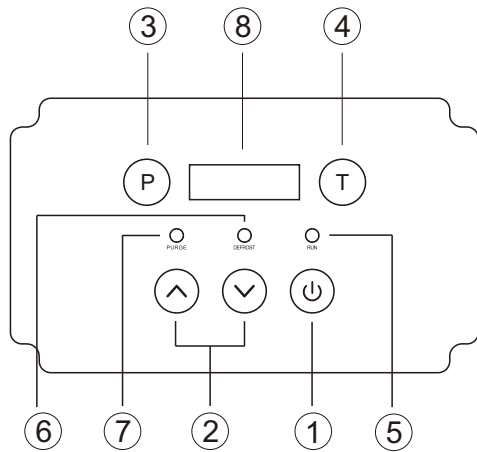

- 1.ON/OFF Key
- 2.UP AND DOWN Key
- 3.PURGE Key
- 4.TIME Key
- 5.Operating Indicator
- 6.Defrosting Indicator
- 7.Purging Indicator
- 8.HUMIDITY AND TIME Display

⏻ ON/OFF: Press the **⏻** key to turn the unit ON or OFF.

P PURGE: Press the **P** key to empty water from the pump reservoir. During normal operation the pump purges automatically when the reservoir is full. Use "PURGE" before moving the machine to avoid water spillage. The pump will close automatically after 40 seconds of continuous operation.

⬆ and ⬇: Press **⬆** and **⬇** key to set or adjust humidity in the range of 26% and 90%. When the environmental humidity is below 26%, "CO" will be displayed.

Defrost Indicator: The unit begins to defrost when the defrost indicator illuminates; the unit has stopped defrosting when the light is no longer illuminated. When defrosting is complete, the unit begins to dehumidify again automatically.

CONTROL PANEL

T TIME: Press this to display working hours and total working time.

- Once the unit is running, the display will show the humidity setting (left) and current humidity (right). Humidity setting can be changed by pressing "Up" or "Down."
- Time settings are based on minutes. For example, if the display shows "0000:50," this means that the unit has worked for 50 minutes since powered on. If you want to view the total working time, press "T" again and the display will show this for 10 seconds, then return automatically to the original working hours. (Pressing "T" before the 10 seconds will return the display to the original working hours.)
- If the unit is powered on but not in operation, the LED will not display anything. If "T" is pressed once, the working hours from the previous time the unit ran will display for 10 seconds. Within the 10 seconds, if "T" is pressed again, the total working time will display for 10 seconds. If there is no action within those 10 seconds, the LED will automatically shut off.
- If "T" is pressed when LED displays the total working time, the LED will shut off immediately. The current working time will be deleted by pressing and holding down "T" for 5 seconds; the time will be reset, but the deleted time will be added into the total working time.

NOTE: The total working time cannot be deleted. If the time is beyond the range of what the LED can show, it will be deleted and restart from zero.

NOTE: If a power outage occurs while the unit is powered on, the unit automatically resumes operation at the most recent settings when power is restored.